

# HAMMER



## AA-1.3BR (H)

### Characteristics:

- Toku hammers have been used for many years in various industries, e.g Demolition, Foundries, Construction etc.
- Toku only use the very best materials in the manufacture of their products giving the tools superior life.
- Due to popular demand we have included a version of this tool to our range with a solid retainer.
- The design of the solid retainer enables the use of pointed chisels as well as standard and wide.



Shank size 14,8mm 6KT / Ø17.3 mm x 60 mm &  
Shank size 14,8mm 6KT / Ø17,5 mm x 60 mm (on request)

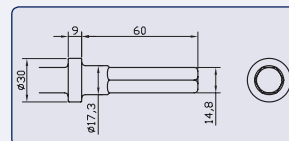

FOR HAMERS  
- Toku AA-1.3B, AA-3B

Ordernumber	Description	L (mm) under the collar	B (mm)
CB3210260	Moil point	260	-
CB3210450	Moil point	450	-
CB418	Round nose	210	-
CB420	Diamond point	155	-
CB3211260	Flat chisel	260	20
CB3211330	Flat chisel	330	20
CB424	Flat chisel	155	50
CB426	Flat chisel	155	38
CB3218200	Wild flat chisel	200	50
CB3218200G	Wild flat chisel, bent	200	60
CB3217210	Wild flat chisel	210	95
CB3217210G	Wild flat chisel, bent	210	95
CBCP6	Adaptor for bush head	200	-
CB27C*	Bush head carbide tip	-	40 x 40

\* 16 teeth carbide metal

Type	Brand	Piston mm	Stroke mm	Blows p/min	J/Blow	Air cons. l/sec	Weight kg	Inlet-thread	Hose-diameter mm	Vibration m/s <sup>2</sup>	Noise level dB(A)
AA-1.3BR (H)	TOKU	24	58	2.800	11,7	7,5	4,5	PT 3/8"	10	10	93

PROFESSIONAL AIRTOOLS

# TOKU